



Let **UK** Home

2 Bedrooms

Flat

Located in London

£4,100 Per Month



info@letukhome.co.uk

<https://www.letukhome.co.uk/>

01795 358 886



8 Dingley Road London

EC1V 8DN



Let UK Home are excited to offer this spectacular two bedroom apartment in the heart of Vermont House part of the 250 City Road.

This property comprises a large bright open plan kitchen and living room leading to a large private balcony with great views, two double bedrooms with fitted wardrobes (master en-suite), a large family sized bathroom and ample storage.

This apartment offers luxury modern living at its finest and the residents will benefit from concierge service, swimming pool and gym, private cinema and residents lounge.

The community is close to Old Street and Angel subway stations, both of which are connected to the Northern Line, with direct access to King's Cross, London Bridge, Canary Wharf, Bond Street and Paddington.

It is only a short walk to London City University and Cass Business School, and the subway can also easily reach other universities such as University College London, London School of Economics, King's College London, University of the Arts London.

8 Dingley Road London

£4,100 Per Month

- 4th Floor
- 24h Security
- The Gym

- Concierge Service
- Swimming Pool
- Cinema & Game Room

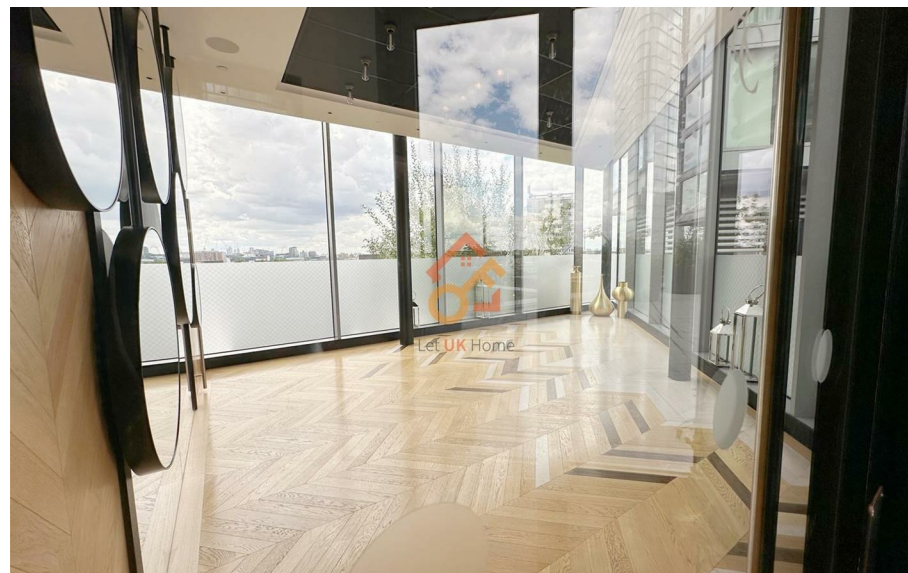



	74.9 SQ M	806 SQ FT
Kitchen/Living/Dining Room	4.30m x 5.99m	14' 1" x 19' 8"
Main Bedroom	3.77m x 4.73m	12' 4" x 15' 6"
Bedroom 2	3.07m x 4.11m	10' 1" x 13' 6"
Balcony	7.3 sq m	78 sq ft



Let **UK** Home

3F 2 Eastbourne Terrace
Paddington
London
W2 6LG

01795 358 886

info@letukhome.co.uk

Council Tax Band: F

Local Authority:

Agents Note: Whilst every care has been taken to prepare these particulars, they are for guidance purposes only. All measurements are approximate and are for general guidance purposes only and whilst every care has been taken to ensure their accuracy, they should not be relied upon and potential buyers/tenants are advised to recheck the measurements.

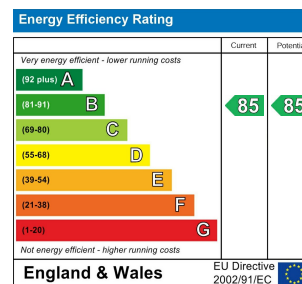

<https://www.letukhome.co.uk/>